

EasyPlus mini 2IN1
Self-Monitoring Blood Glucose System
Quick Reference Guide

Installing Batteries



1. Flip open the battery door by pushing the tab in the direction of the arrow and pulling the door up.



2. Insert a battery.





3. Put the battery door back in place and snap it closed. The meter beeps and turns on automatically.

Setting The Time and Date—First Time Use

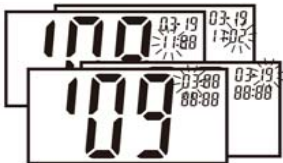
Setting the current time and date in your meter is important if you intend to use the meter memory or if you want to download your results to a computer.







1. If your meter does not turn on automatically, press  for 3 seconds to turn on the meter.
2. The last 2-digits of the year flash at the center of the display. Press  to adjust the year and press  to confirm the setting.
3. Repeat step 2 to set the date and time. The flashing field is the one you are currently setting. When finishing the setting, the meter beeps.

Running A Control Solution Test

You need the meter, a test strip, and control solution.



1. Put a test strip into the meter in the direction of the arrow.
2. The meter beeps and turns on automatically. The icon  shows itself.
3. Press the , the icon  shows and the meter is ready to run a Control Solution Test.
Or press  to cancel the Control Solution Test Mode.
4. Place the meter on a flat surface, like a table.
5. Remove the control solution bottle cap and wipe the tip of the bottle with a tissue.



6. Squeeze the bottle until a tiny drop forms at the tip of the bottle.

7. Touch the drop to the blood collection area at the tip of the test strip. When you hear beeps, you have enough control solution in the test strip.



8. The meter starts to count down from 5 seconds, the display shows "Ok", and then shows the test result.

9. Do not remove the test strip yet. Check if the reading falls within the range printed on the test strip bottle.

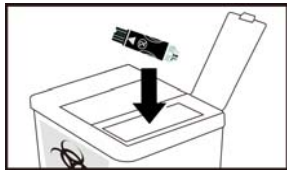

10. Remove the test strip and throw it away after you have compared the reading to the range printed on the test strip bottle.

Inserting A Lancet Into The Built-in Lancing Device

You must first load the lancet into the lancing device to get it ready for use.



1. Unscrew the Cap.

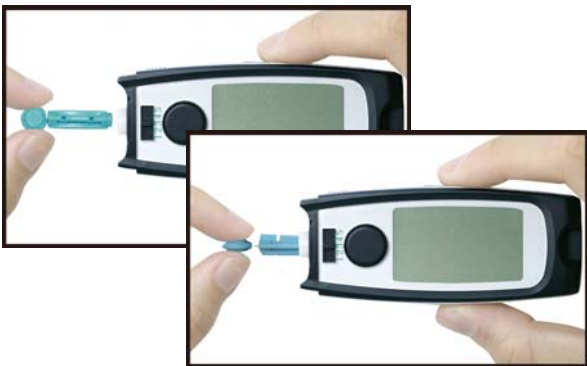

2. Insert a new disposable lancet firmly into the carrier and then twist off the protective cover.



3. Recap the front cap.



4. Select the desired penetration depth.



Select 1-2 for thick or calloused skin. 3 for average. 4-5 for soft or thin skin.



5. Pull on the cocking button of the lancing device until it clicks and then release. Now the lancing device is ready. Do not prick your finger until your meter and strip are prepared.
6. Set the lancing device aside until later in the test.

Running A Blood Glucose Test With Blood From Your Fingertip



1. Wash your hands with soap and warm water. Rinse and dry thoroughly.



2. Put a test strip into the meter in the direction of the arrow. The meter beeps and turns on automatically.
3. When the blood drop flashes on the display, using the lancing device.



4. Hold the lancing device firmly against the side of your finger. Press the release button. Then remove the lancing device from your finger.

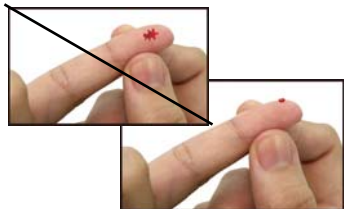

5. Gently squeeze and/or massage your fingertip until a round drop of blood on your fingertip.



6. Touch the blood drop at the tip of the transparent window of the test strip. Do not put blood on top of the strip. When you hear beeps, you have enough blood in the test strip. Be sure to get enough blood in the test strip. Otherwise, an inaccurate reading may result.



7. The meter starts to count down from 5 seconds, the display shows “Ok”, and then shows the test result.
8. Remove the test strip and the meter turns off automatically.

Discarding Used Lancets





1. Unscrew and remove the cap. Without touching the used lancet, stick the lancet tip into its protective cover. Grip the lancet carrier firmly and pull the lancet safely out.

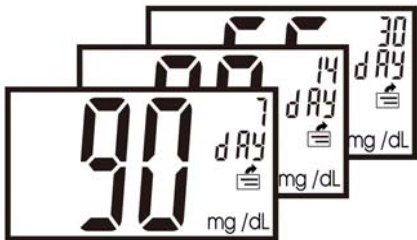

2. Discard the used disposable lancet into an appropriate sharps or biohazard container.

Viewing & Deleting Test Results





1. Press  to turn the meter on.
2. Press  to view averages for 7/14/30 days.





3. Continue to press  to view the test result from latest to oldest.



4. To delete a test result, press  for 3 seconds. When display shows "dEL", press  to confirm the deletion.

Or press  to cancel the deletion and go back to the total number of the stored results.



5. Press  for 1 second to go back to the total number of the stored results.
6. Press  for 3 seconds to turn off the meter, or the meter turns off automatically in 120 seconds.

Screen Messages And Troubleshooting

Never make treatment decisions based on an error message. If you have any concerns, please contact your healthcare professional.



What it means ?

System err.

What to do ?

Please replace the batteries first. If Err appears again, please contact your healthcare professional immediately.



Humidified or used strip.

Please replace with a new strip.



What it means ?

Memory err.

What to do ?

Please replace the batteries first. If Err appears again, please contact your healthcare professional immediately.



Low power.

Please replace with a new battery.



What it means ?

You may have a very high blood glucose level (severe hypoglycemia), over 630 mg/dL.



You may have a very low blood glucose level (severe hypoglycemia), lower than 20 mg/dL.

What to do ?

Please test again and if you get the same result, please contact your healthcare professional immediately.

Please test again and if you get the same result, please contact your healthcare professional immediately.



What it means ?

Temperature is too high, outside the required range of 10°C - 40°C (50°F - 104°F). This alerts users that an incorrect result may occur if the test continues.

Temperature is too low, outside the required range of 10°C - 40°C (50°F - 104°F). This alerts users that an incorrect result may occur if the test continues.

What to do ?

Relocate the meter to a location with temperature between 10°C - 40°C (50°F - 104°F).

Relocate the meter to a location with temperature between 10°C - 40°C (50°F - 104°F).



Manufacturer:

EPS Bio Technology Corp.

No.8, R&D RD III, Hsinchu Science Park, Hsinchu, Taiwan 30077

Tel: +886-3-6686868 Fax: +886-3-6686866

E-mail: info@epsbio.com.tw Website: <http://www.epsbio.com.tw>



Obelis s.a.

Boulevard Général Wahis 53, 1030 Brussels, BELGIUM

TEL : (32) 2.732.59 54 FAX : (32) 2.732.60 03

E-mail: mail@obelis.net

